

Description & Features

HT pumps are designed in accordance with all requirements of UL standard for safety (UL448). HT pumps are optimized hydraulic pump design, brought high efficiency and the performance of energy conservation.

Model Instruction

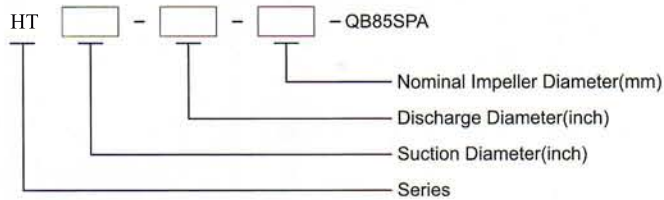

For instance, suction diameter 2.5inch, discharge diameter 1.5inch, nominal Impeller Diameter 250mm, its name HT2515250.

Material Code

- Q: Ductile Iron Casing
- B85: Bronze Impeller
- S: ASTM 420 Shaft
- P: Gland Packing
- A: ANSI Flange

Product standard

Pump installing dimension is conforming to ISO 2858 standard. Performance is meeting with UL448-2013 regulation.

Flange standard

- ASME B16.42-1998 CLASS150(HT2515250、 HT32250、 HT425250、 HT53250)
- ASME B16.42-1998 CLASS300(HT53315、 HT54315)

Operating Data

Suction Diameter	2.5 ~ 5 inch
Discharge Diameter	1.5 ~ 4 inch
Flowrate(Q)	50 ~ 750 usgpm
Head(H)	84 ~ 230 psi
Speed	2900 rpm
Working Pressure	200 ~ 290 psi



Horizontal End-Suction Fire Pump

Explode View & List of Parts

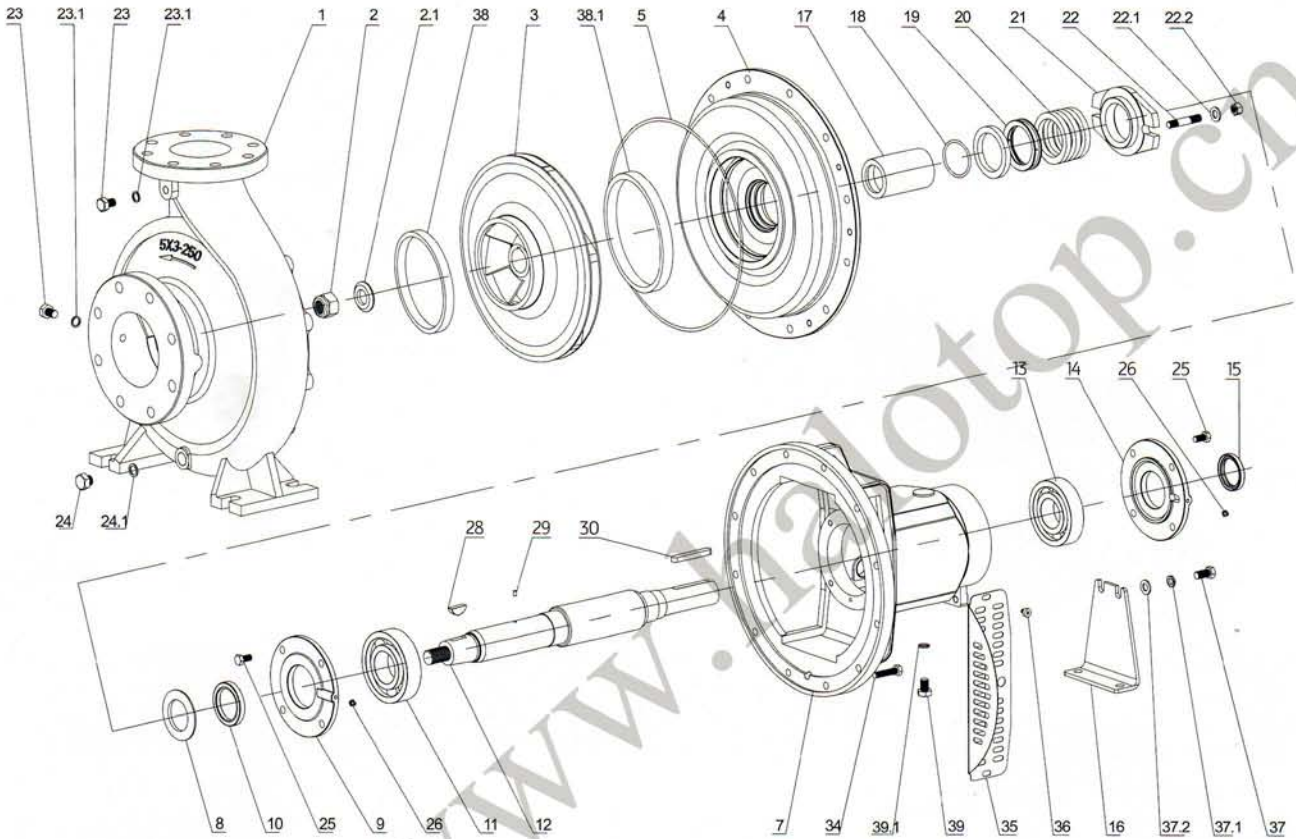

Code	Part Name
1	Casing
2	Impeller Nut
2.1	Lock washer for impeller
3	Impeller
4	Gland Cover
5	O-ring
7	Bearing Housing
8	Rubber Slinger
9	NDE Bearing Cover
10	NDE Oil Seal
11	NDE Bearing
12	Shaft
13	DE Bearing
14	DE Bearing Cover
15	DE Oil Seal

Code	Part Name
16	Support Foot
17	Packing Sleeve
18	O-ring
19	Gland Packing
20	Packing Seal Cage
21	Gland Cover
22	Stud Bolt
22.1	Flat Washer
22.2	Screw Nut
23	Plug
23.1	Plug Spacer
24	Plug
24.1	Plug Spacer
25	Screw Bolt

Code	Part Name
26	Oil Cup M6
28	key
29	pin
30	key
34	Screw Bolt
35	Protective cover
36	Bolt
37	Screw Bolt
37.1	Elastic Washer
37.2	Flat Washer
38	Front-Wearing
38.1	Back-Wearing
39	Plug
39.1	Plug Spacer

NOTE: HT53315 & HT54315 Lacking of parts No. 14, 15 & 26.

Installation Dimensions

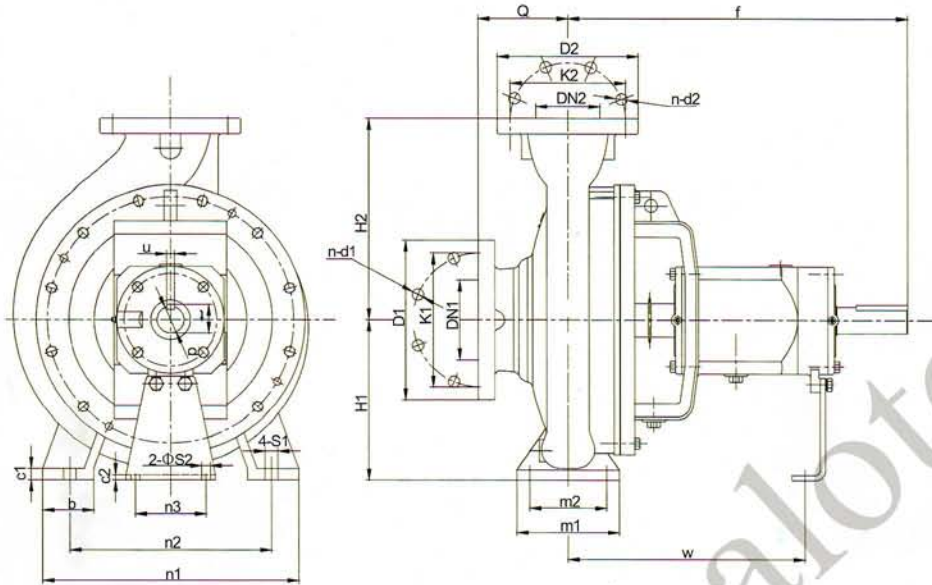

Model	DN1		DN2		Impeller Dia.	Shaft No.	a	f	h1	h2	b	m1	m2	n1	n2	n3	c1	c2	w	S1	S2	d	t	u	l	Weight (kg)
	inch	mm	inch	mm																						
HT2515250	2.5"	65	1.5"	40	250	2	100	500	180	225	65	125	95	320	250	110	14	6	370	M12	M12	32	35	10	80	71
HT32250	3"	80	2"	50	250	2	125	500	180	225	65	125	95	320	250	110	15	6	370	M12	M12	32	35	10	80	76
HT425250	4"	100	2.5"	65	250	2	125	500	200	250	80	160	120	360	280	110	16	6	370	M16	M12	32	35	10	80	84
HT53250	5"	125	3"	80	250	2	125	500	225	280	80	160	120	400	315	110	18	6	370	M16	M12	32	35	10	80	88
HT53315	5"	125	3"	80	315	3	125	530	250	315	80	160	120	400	315	110	20	8	370	M16	M12	42	45	12	110	130
HT54315	5"	125	4"	100	315	3	140	530	250	315	80	160	120	400	315	110	19	8	370	M16	M12	42	45	12	110	138

DN1/DN2	Flange standard : ASTM B16.42-1998 Class150					Flange standard : ASTM B16.42-1998 Class300				
	1.5"	2"	2.5"	3"	4"	5"	3"	4"	5"	
D1/D2	127	152.4	177.8	190.5	228.6	254	209.6	254	279.4	
K1/K2	98.6	120.7	139.7	152.4	190.5	215.9	168.1	200.2	234.9	
n-d1/ n-d2	4-φ15.7	4-φ19.1	4-φ19.1	4-φ19.1	8-φ19.1	8-φ22.4	8-φ22.4	8-φ22.4	8-φ22.4	

Description & Features

HT series are designed in accordance with all requirements of UL standard for safety (UL448). ESF pumps are of high flow rate, high efficiency, stable operation, low noise and long service life, easy to install and maintain.

Model Instruction

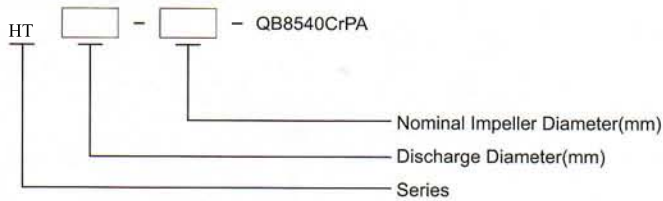

For instance, discharge diameter 150mm, nominal Impeller Diameter 360mm, its name HT150-360.

Material Code

Q: Ductile Iron Casing
C250: Cast Iron Casing
B85: Bronze Impeller
40Cr: 40CR Shaft
P: Gland Packing
A: ANSI Flange

Product standard

Performance is meeting with UL448-2013 regulation.

Flange standard

ASME B16.42-1998 CLASS300, ASME B16.42-1998 CLASS250

Operating Data

Suction Diameter	150-200 mm
Discharge Diameter	100-150 mm
Flowrate(Q)	450-2000 usgpm
Head(H)	82-304 psi
Speed	2900 rpm
Working Pressure	230 ~ 400 psi



Explode View & List of Parts

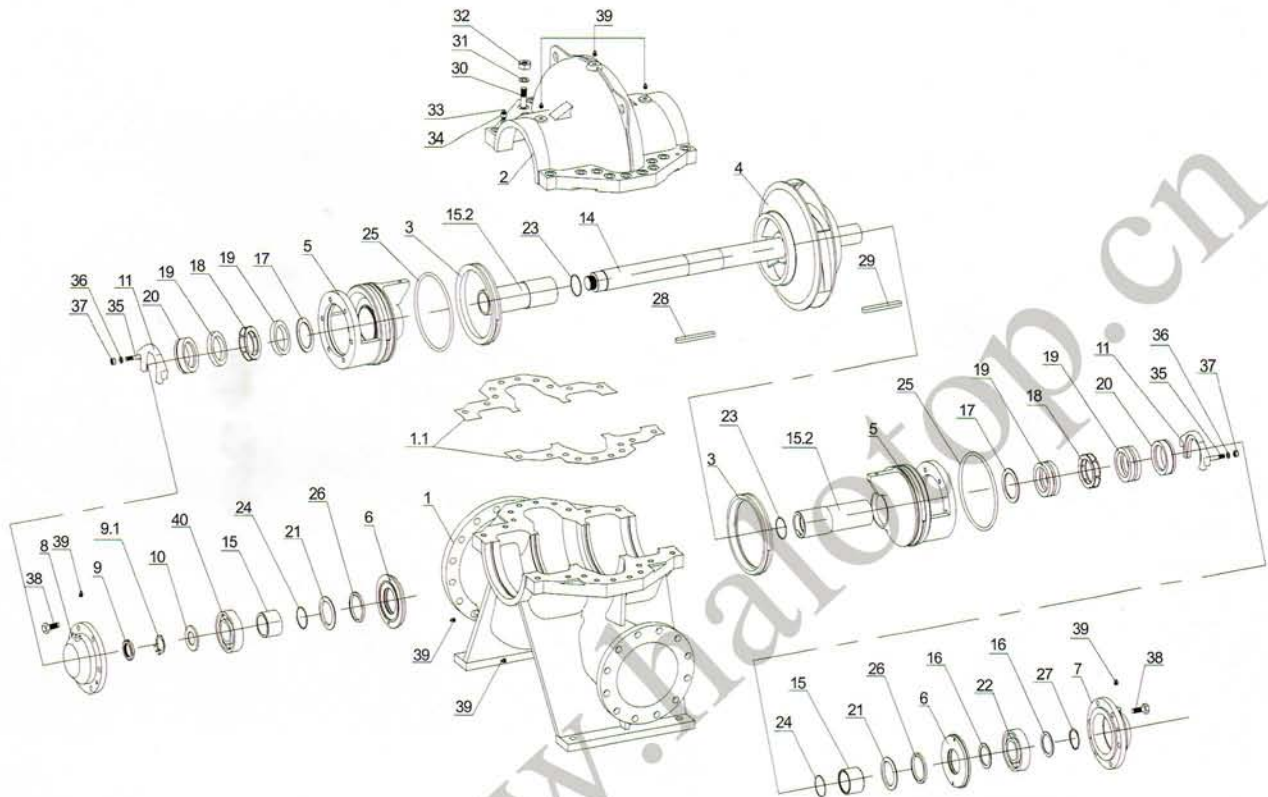

Code	Part Name	Code	Part Name	Code	Part Name
01	Casing-Bottom	15	Shaft Sleeve-Short	28	Key
01.1	Casing Gasket	15.2	Packing Shaft Sleeve	29	Key
02	Casing-Top	16	Bearing Seal Plate	30	Screw Bolt
03	Wear Ring	17	Packing Seal Plate	31	Spring Washer
04	Impeller	18	Lantern Ring	32	Screw Nut
05	Seal Housing	19	Gland	33	Pin
06	Bearing Cover	20	Packing Cover	34	Screw Nut
07	Bearing Housing-Driver End	21	Slinger	35	Screw Bolt
08	Bearing Housing-Non-Driver End	22	Bearing	36	Flat Gasket
09	Screw Nut	23	O-ring	37	Screw Nut
09.1	Lock Washer for Nut	24	O-ring	38	Screw Bolt
10	Bearing Slinger	25	O-ring	39	Plug
11	Seal Plate	26	Felting	40	Bearing
14	Shaft	27	External Circlips		

Horizontal Split-case Fire Pump

Installation Dimensions

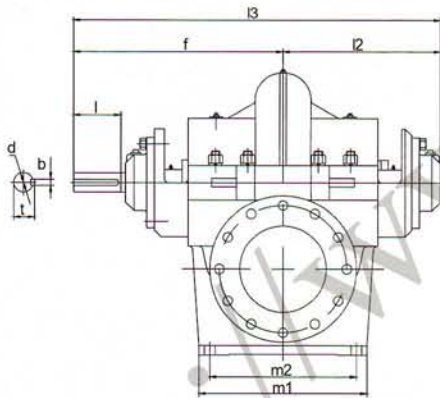
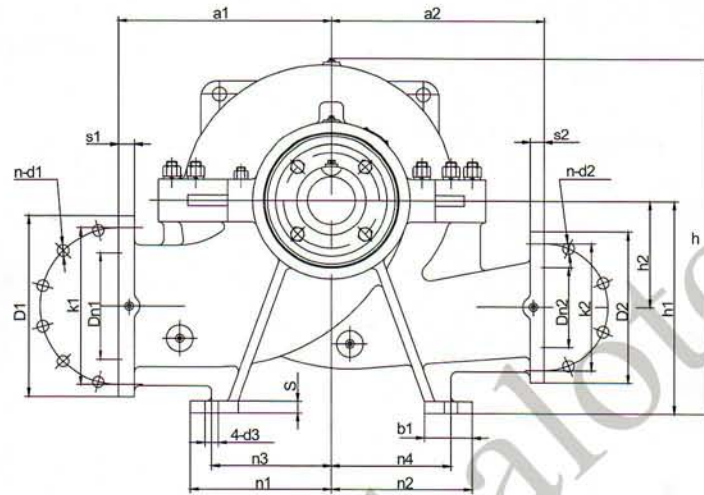

ASME16.42-1998 CLASS300,ASME16.42-1998 CLASS250

DN	80	100	125	150	200
D	209.6	254	279.4	317.5	381
K	168.1	200.2	235	269.7	330.2
n	8	8	8	12	12
d	22.4	22.4	22.4	22.4	25.4

Model	DN1	DN2	a1	a2	f	l2	l3	h	h1	h2	m1	m2	n1	n2	n3	n4	b1	d3	s	d	b	l	t	Weight (kg)	
HT100-250	150	100	342	339	385	300	685	570	355	170	320	270	235	235	200	200	80			φ34	10	80	37.3	230	
605								283																	
620								270																	
HT100-375	200	125	382	380	485	365	850	635	400	200	390	340	265	265	225	225	90	φ25	22		12	110	42.3	270	
665								322																	
660								342																	
670								355																	
HT125-290	150	150	412	412		390	875	660	400	210														52.8	385
660								355																	
670								385																	